



Meaningful Innovation.

WEEE Number: 80133970

# INSTRUCTION MANUAL

## SMART MAGNETIC LINEAR LIGHT

### TECHNICAL DATA

Model	VT-3621
SKU	6885
Input voltage	DC:48V
Lumens	2000LM
Power	20W
Beam Angle:	30'D
CRI	>90
Body Type	Aluminum



**03** YEAR  
**WARRANTY\***



### INTRODUCTION & WARRANTY

Thank you for selecting and buying MAGNETIC SMART TRACKLIGHT V-TAC will serve you the best. Please read these instructions carefully before starting the installation and keep this manual handy for future reference. If you have any other query, please contact our dealer or local vendor from whom you have purchased the product. They are trained and ready to serve you at the best. The warranty is valid for 3 years from the date of purchase. The warranty does not apply to damage caused by incorrect installation or abnormal wear and tear. The company gives no warranty against damage to any surface due to incorrect removal and installation of the product. The products are suitable for 10-12 Hours Daily operation. Usage of product for 24 Hours a day would void the warranty. This product is warranted for manufacturing defects only.

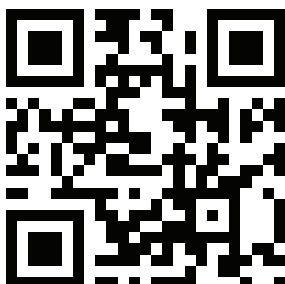

### MULTI-LANGUAGE MANUAL QR CODE

Please scan the QR code to access the manual in multiple languages.



FR

Cet appareil, ses accessoires et cordons se recyclent

À DÉPOSER EN MAGASIN



À DÉPOSER EN DÉCHÈTERIE



OU

Points de collecte sur [www.quefairedemesdechets.fr](http://www.quefairedemesdechets.fr)  
Privilégiez la réparation ou le don de votre appareil !

## WARNING

1. Please make sure to turn off the power before starting the installation.
2. Installation must be performed by a certified person.
3. Proper grounding should be ensured throughout the installation.
4. For Indoor use only



This marking indicates that this product should not be disposed of with other household wastes.

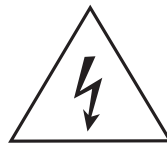

Caution, risk of electric shock.

## INSTALLATION INSTRUCTION

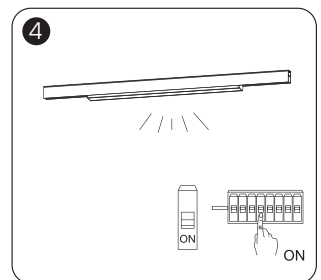
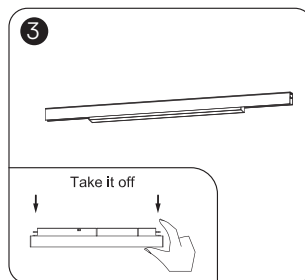
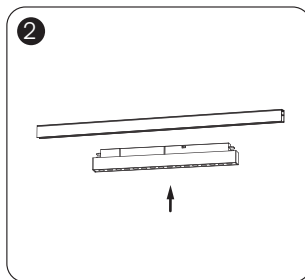
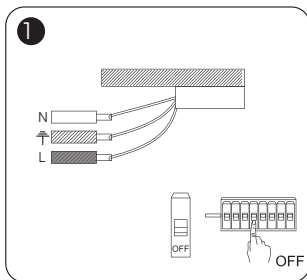

1. Switch off the power.
2. Install the luminaire into the guide rail groove .
3. Check that everything is in order.
4. Switch on the power if above steps done properly without any mistakes.

## APP INSTALLATION

Step 2: Scan the given QR code, or download "Smart Life" from the App Store (iOS) or the Google Play Store (Android).



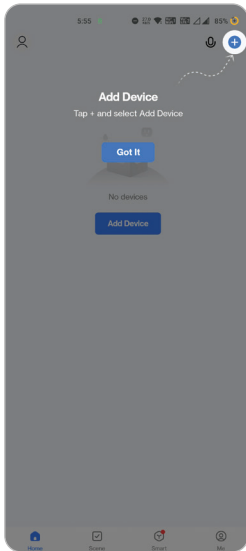

4. Enable Bluetooth and Home Wifi for the device to access your wifi connection for pairing

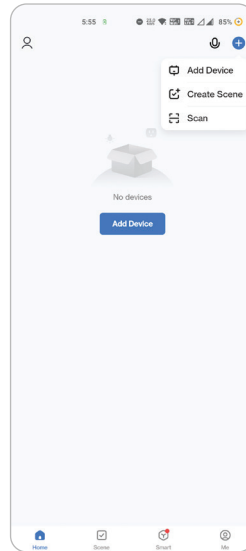

5. Click "Add a device" or "+" in the top right corner.

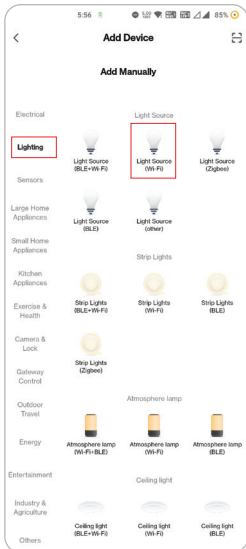

6. Click on the Lighting choose "Light Source (Wi-Fi)"

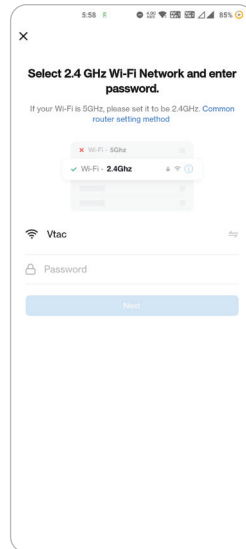

7. Select 2.4GHz Wi-Fi network and enter the password

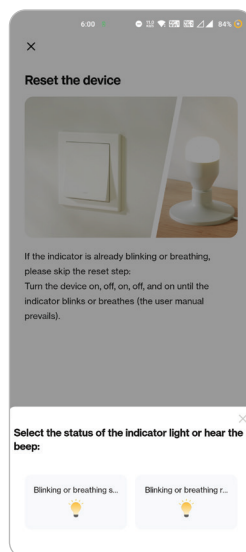
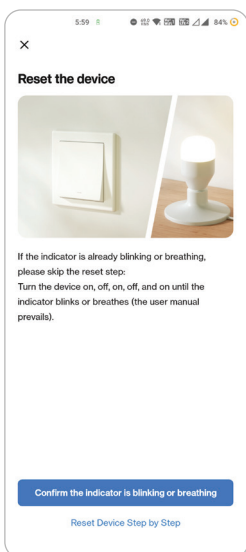

Step 8: To pair the device with LED Smart Strip Light make sure the light is blinks rapidly. Once the light blinks rapidly, the light is in pairing mode. If the light is not blinking rapidly, you can do one of the following steps:

- Switch the light on & off repeatedly for 3 times, with short intervals of less than 2 seconds.
- Tap the 'How to make light blink rapidly' link (as shown on the image to the right)
- You can also enable pairing mode from the Wi-Fi controller. Press and hold the ON/OFF button for 5-7 seconds and wait till you observe the light flashing. Please refer to the instruction section "WI-FI CONTROLLER FUNCTIONS"

#### Network Modes

- 1) Smart Mode: Light flashes rapidly.
  - 2) AP mode: Slow flash, once every 2 seconds.
- Confirm if the light blinks rapidly, select the Wi-Fi network, and enter the password.

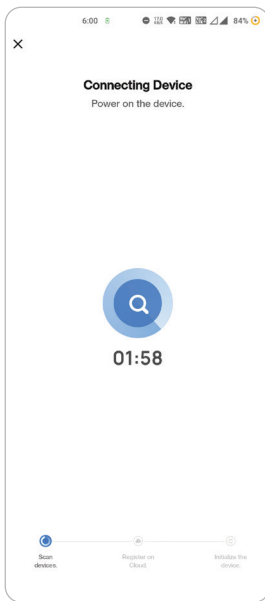

Step 8: Once you have successfully completed step 10, you will be redirected to below page, where the App searches, registers and initializes the device(lamp) (ref image below).

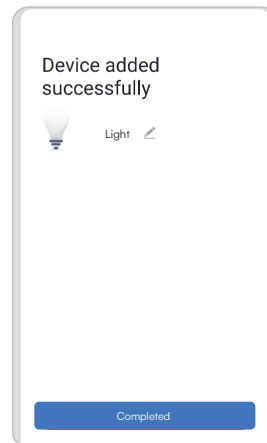

Step 9: Once your device is successfully added, rename the device to your preference.

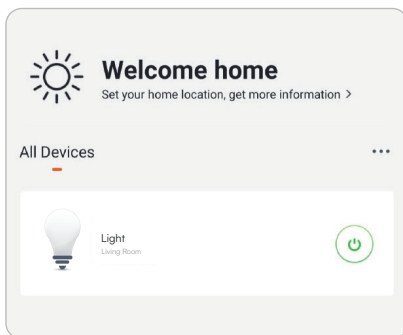

Step 10: You can now start controlling your device with the App. Tap the device name on the home page to enter the controls and features of the device.

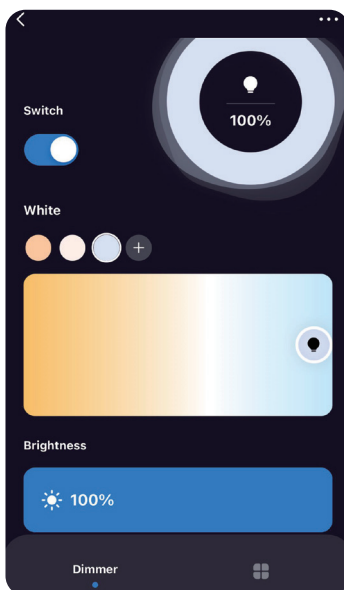

Step 13: After successfully pairing the lamp with the app, you can start controlling multiple features of the lamp through your mobile- on/off switch, changing the colour temperature, timing & schedules, dimming options, and more.

---

## GOOGLE ASSISTANT SETTINGS

- Install the Google Assistant app via the App Store (iOS) or the Play Store (Android) and register. If you already have an existing account with Google Assistant, please proceed to logging in.
- Create a New Home/Choose from the existing home if any.
- Power ON the Google Assistant device and connect it to the App.(Then Proceed to step 2)

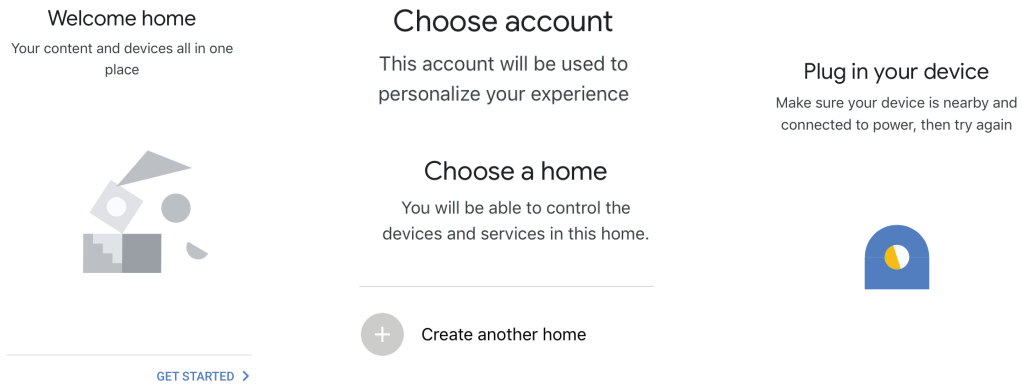

- Once you are on the Google home page, tap on the Add "+" icon— to add a new device and skill. And then tap on Set up device as shown in below image.

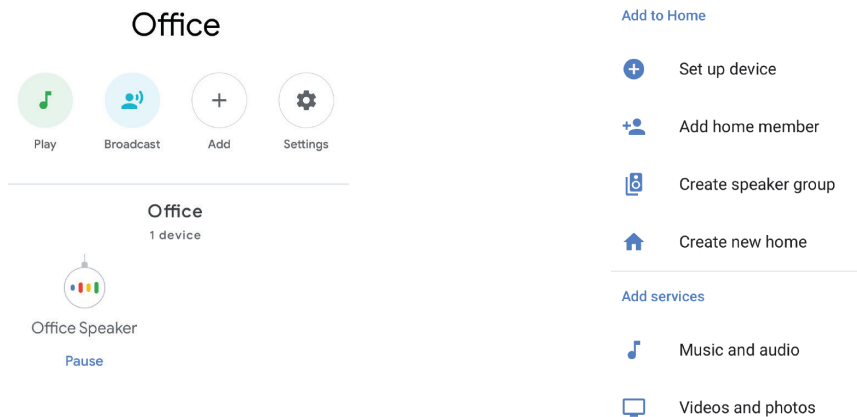

- Step 3: Make sure the Wifi Switch is paired with Smart Life app before starting, Tap on the arrow section as highlighted in the below image.
  - Step 4: Type "Smart Life" on the search bar and tap on the icon of "Smart Life"
-

## Set up

Set up new devices or add existing devices and services to your home

### New devices



#### Set up new devices

Google Home, smart displays and devices labelled 'Made for Google' such as C by GE smart bulbs

### Works with Google



#### Have something already set up?

Link your smart home services such as Philips Hue and TP-Link

## Smart Life

- Step 5: Sign In with your Smart Life Login credentials to Link the Smart Life device.
- Step 6: Tap on Authorize in order to proceed to linking the device.

+1 Phone Number/Email Address

Type your password here

Link Now

[Forgot Password](#) [Help](#)



Google will be able to:  
Receive your public profile  
Control your devices over internet

Authorize

## Step 7

- a. Account will now be linked, please stay on the page you will be redirected in few seconds to select the device to add to your home.
- b. Select the device and tap on Next as show in image b.

Done assistant.google.com

a. Account is now Linked

b. Choose device

home light Light

NEXT >

## Choose a home

You will be able to control the devices and services in this home.

- Smart-Home
- Office
- Smart Home
- Create another home

NEXT >

Step 8: Select the Home where you would like to add the Smart Life under. (Or) you can create a New home in order to add the Smart Life to it.

Step 9: You have successfully added Smart Life device to your Google Assistant App.

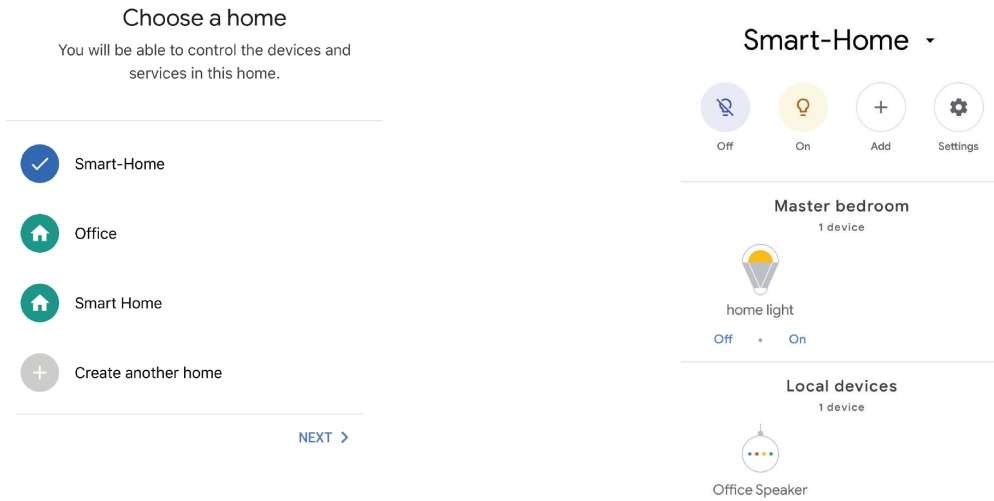

Step 10

a. You can turn the Lamp On/OFF by tapping on On/Off options as shown below. (OR) You can tap on the Smart Lamp.

b. You will be redirected to page(as shown in image b) where you can control the lights "Power and Dimming functionality".

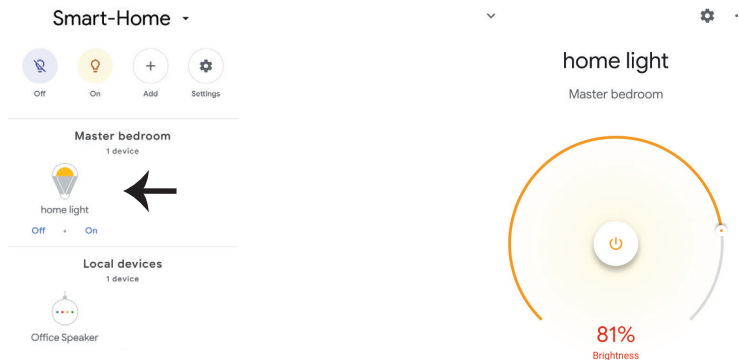

---

## Google Commands

Now, you can control your smart device using voice commands on Google Assistant. Below are a few commands you can use:

*Ok, Google, turn on/off bedroom light,*  
*Ok, Google, turn on/off Hall light.*

## THINGS TO REMEMBER BEFORE STARTING INSTALLATION

1. Smart Life App & Google Assistant App Ok, Google, set bedroom light to warm white.
2. Make sure you have Google Assistant Device
3. Smart Device - Lamp
4. Stable Wifi network

## ALEXA SETTINGS

Step 1: Install the Amazon Alexa app via the App Store (iOS) or the Play Store (Android) and register. If you already have an existing account with Amazon Alexa, please proceed to logging in.

Step 2: Once you are on the Amazon Alexa home page, tap on the lower right icon — where the arrow is pointed — to add a new device and skill.

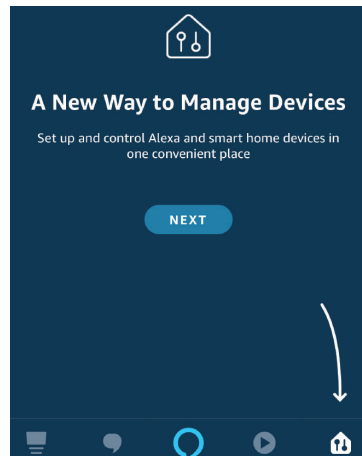
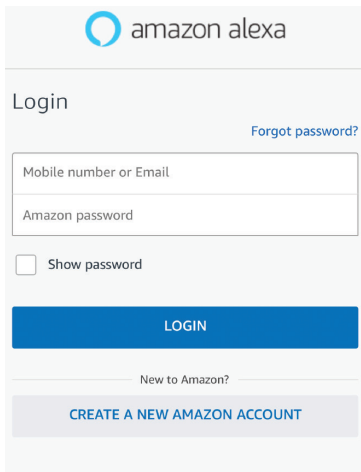

Step 3: Tap on  settings and tap on "skills and games" as shown below.

Step 4: Search for 'Smart Life' on the "Skills & Games" page as shown below.

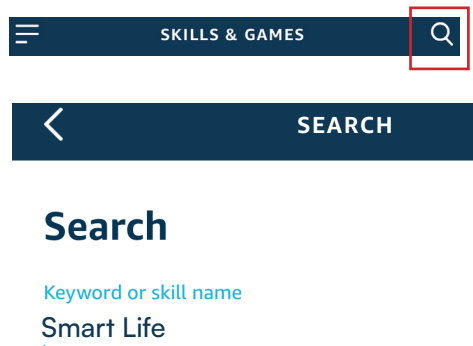
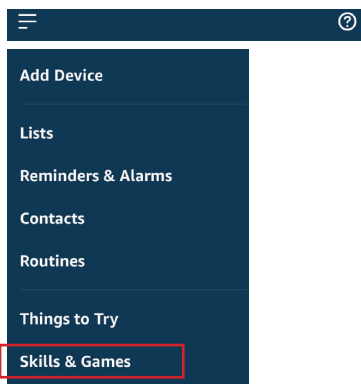



Step 5: Enable the Skill

Step 6: Enter your Smart Life login ID and password and tap on “Link Now”

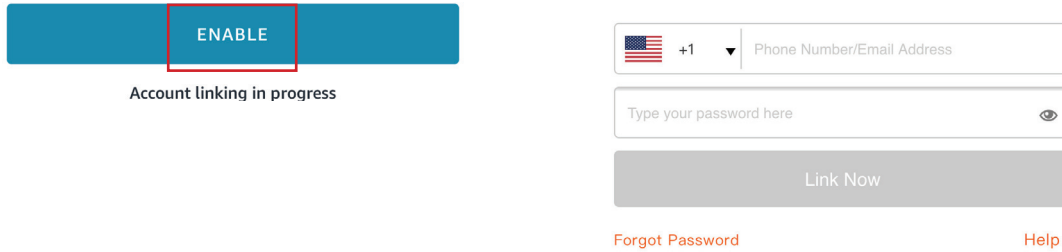

Step 7: Once you tap on Link Now, you will be redirected to a new page requesting for authorization(Ref Image below). Tap on “Authorize”

Step 8: You will receive confirmation of the account being linked successfully (Ref Image below)

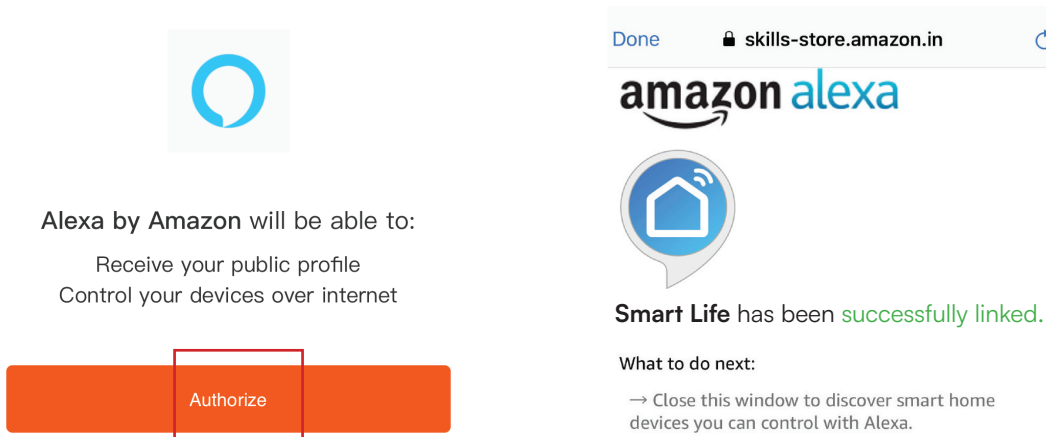

Step 9: Discover your smart device on Alexa. Once you have enabled the skill

A) You can use voice command “Alexa discover devices” to the Alexa device which you have.

B) To add device manually on home page tap on  and tap on Add device , select the device which you are adding and tap on discover device.

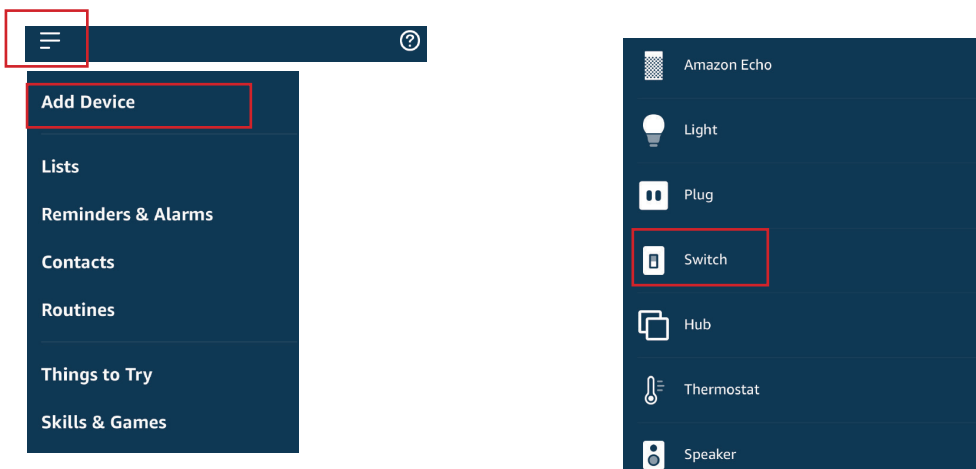

Note: Discovering the device must be done every time the device’s name is changed on the app.

---

## ALEXA COMMANDS

Now, you can control your smart device using voice commands on Alexa.  
Below are a few commands you can use:

*Hi Alexa, Turn On/Off bedroom light.*

*Hi Alexa, Turn On/Off Hall Light.*

## THINGS TO REMEMBER BEFORE STARTING INSTALLATION

1. Smart Life App & Amazon Alexa App
2. Make sure you have Amazon Alexa Device(including Echo, Echo Tap, or Echo Dot)
3. Smart Device - Lamp
4. Stable Wifi network



IN CASE OF ANY QUERY/ISSUE WITH THE PRODUCT, PLEASE REACH OUT TO US AT: [SUPPORT@V-TAC.EU](mailto:SUPPORT@V-TAC.EU)  
FOR MORE PRODUCTS RANGE, INQUIRY PLEASE CONTACT OUR DISTRIBUTOR OR NEAREST DEALERS.  
V-TAC EUROPE LTD. BULGARIA, PLOVDIV 4000, BUL.L.KARAVELOW 9B

IN CASE OF ANY QUERY/ISSUE WITH THE PRODUCT, PLEASE REACH OUT TO US AT: [SUPPORT@V-TAC.EU](mailto:SUPPORT@V-TAC.EU)  
FOR MORE PRODUCTS RANGE, INQUIRY PLEASE CONTACT OUR DISTRIBUTOR OR NEAREST DEALERS.  
V-TAC WEST EUROPE LTD. GROUND FLOOR, 71 LOWER BAGGOT STREET, DUBLIN 02, IRELAND D02 P593

IN CASE OF ANY QUERY/ISSUE WITH THE PRODUCT PLEASE REACH OUT TO US AT  
[SUPPORT@VTACEXPORTS.COM](mailto:SUPPORT@VTACEXPORTS.COM) V-TAC HOUSE, KELPATRICK ROAD, SLOUGH, BERKSHIRE, SL1 6BW, UK.

---