



Meaningful Innovation.

WEEE Number: 80133970

INSTRUCTION MANUAL

LED BOLLARD LIGHT

TECHNICAL DATA

MODEL	VT-820
SKU	128325, 128326, 128333 218325, 218326, 218328, 218333
WATTS	10
LUMENS	1000
INPUT POWER	AC:220-240V, 50Hz
UNIT COLOR	Grey
BODY TYPE	Aluminium
ON/OFF CYCLES	>15000
LED CHIP TYPE	COB-CREE
BEAM ANGLE	110°
CRI	>80
LONG LIFE	20,000 Hours
DIMENSION	800x148x148mm



02 YEAR
WARRANTY*

IP65
RATING

INTRODUCTION & WARRANTY

Thank you for selecting and buying V-TAC product. V-TAC will serve you the best. Please read these instructions carefully before starting the installing and keep this manual handy for future reference. If you have any another query, please contact our dealer or local vendor from whom you have purchased the product. They are trained and ready to serve you at the best. The warranty is valid for 2 years from the date of purchase. The warranty does not apply to damage caused by incorrect installation or abnormal wear and tear. The company gives no warranty against damage to any surface due to incorrect removal and installation of the product. The products are suitable for 10-12 Hours Daily operation. Usage of product for 24 Hours a day would void the warranty. This product is warranted for manufacturing defects only.

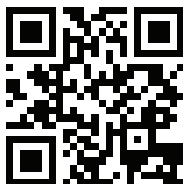

MULTI-LANGUAGE MANUAL QR CODE

Please scan the QR code to access the manual in multiple languages.



FR

Cet appareil,
ses accessoires
et cordons
se recyclent

À DÉPOSER
EN MAGASIN



À DÉPOSER
EN DÉCHÈTERIE



Points de collecte sur www.quefairedemesdechets.fr
Privilégiez la réparation ou le don de votre appareil !



This marking indicates that this product should not be disposed of with other household wastes.



Caution, risk of electric shock.

WARNING

1. Please turn off power and read this instruction before starting the installation.
2. Install only by certified Electrician.
3. Proper grounding should be ensured throughout the installation.

STRUCTURE

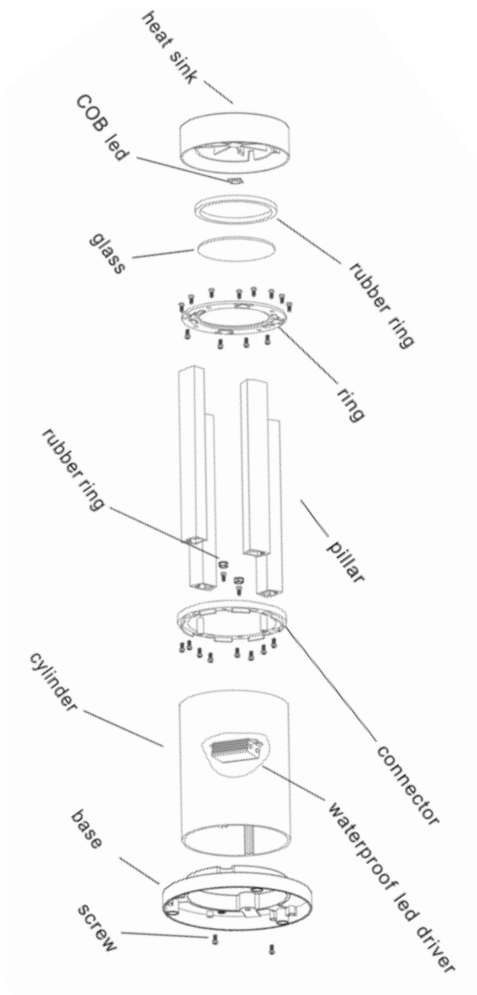

INSTALLATION INSTRUCTIONS

1. Switch off the power before installing the lamp.
2. To drill the appropriate holes on the cement floor. (Picture 1)
3. Do the waterproof measure for the wire junction and then Connect the electricity AC:100-240V. (Picture 2)
4. Fix the lamp on the floor by screw. (Picture 3)
5. Cover the nut cap and switch on the power if above steps are done properly without any mistakes. (Picture 4)

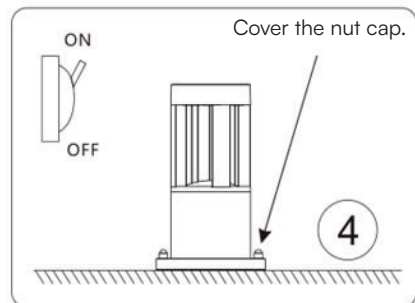
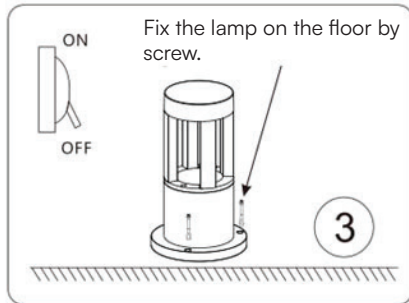
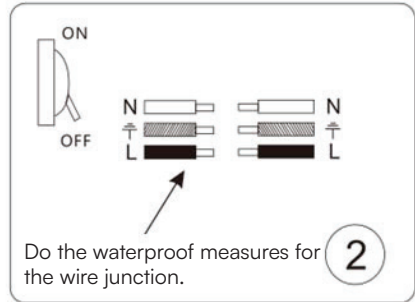
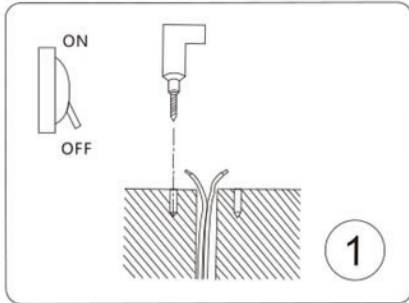

IN CASE OF ANY QUERY/ISSUE WITH THE PRODUCT, PLEASE REACH OUT TO US AT: SUPPORT@V-TAC.EU
FOR MORE PRODUCTS RANGE, INQUIRY PLEASE CONTACT OUR DISTRIBUTOR OR NEAREST DEALERS.
V-TAC EUROPE LTD. BULGARIA, PLOVDIV 4000, BUL.L.KARAVELOW 9B

IN CASE OF ANY QUERY/ISSUE WITH THE PRODUCT, PLEASE REACH OUT TO US AT: SUPPORT@V-TAC.EU
FOR MORE PRODUCTS RANGE, INQUIRY PLEASE CONTACT OUR DISTRIBUTOR OR NEAREST DEALERS.
V-TAC WEST EUROPE LTD. GROUND FLOOR, 71 LOWER BAGGOT STREET, DUBLIN 02, IRELAND D02 P593

IN CASE OF ANY QUERY/ISSUE WITH THE PRODUCT PLEASE REACH OUT TO US AT
SUPPORT@VTACEXPORTS.COM V-TAC HOUSE, KELPATRICK ROAD, SLOUGH, BERKSHIRE, SL1 6BW, UK.